

Unisub Premium Coaster Tip Sheet

MATERIALS NEEDED:

- Unisub Premium Coaster
- Printed Transfer From a Sublimation Printer
- Heat Tape
- Scissors
- Clean Lint-Free Cloth or Compressed Air
- Heat Resistant Gloves
- Protective Paper
- Heat Press set to 385° F or 195° C



INSTRUCTIONS

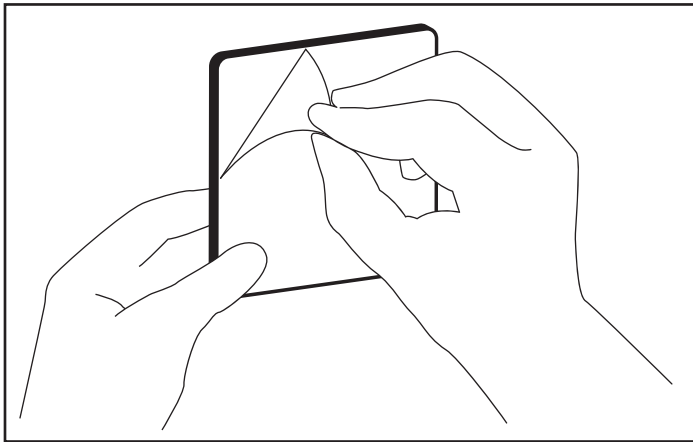

Step 1: Peel film off the coaster. Clean the surface of the coaster with a clean lint-free cloth, and all-purpose cleaner, or a can of compressed air. This will ensure nothing is on the surface of your product for sublimation.

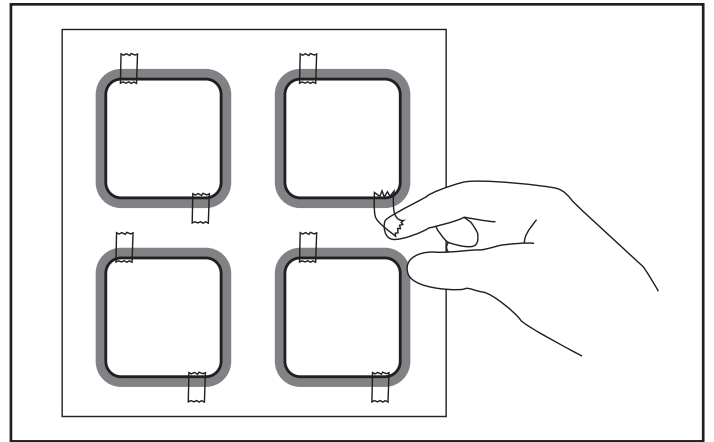

Step 2: Line up the coaster to the transfer. Using heat tape, secure the coaster to the transfer. With bare sides facing up, place in heat press. Time may vary based on equipment. You may need to increase time if pressing more than one coaster at a time.

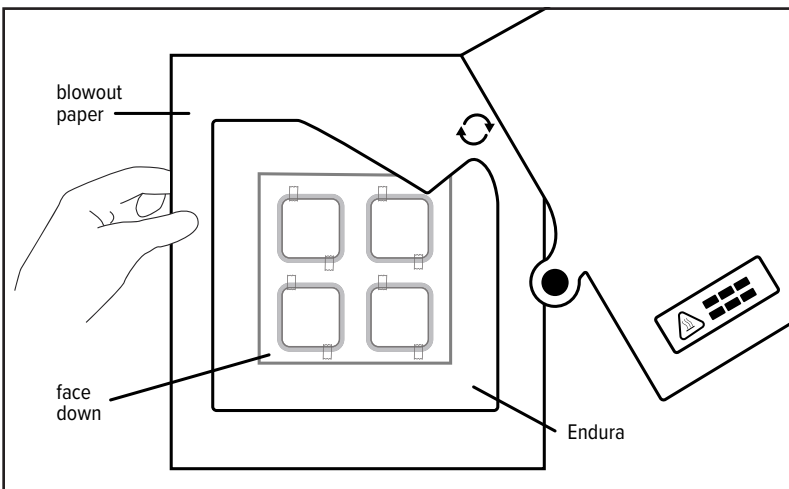

Product	Temperature	Time
Premium Coaster	385° F / 195° C	0:60 - 0:70

Step 3: Once your timer is done, remove the transfer paper from the coaster and move the coaster off of the press to a cooling rack.

ATTENTION: the item will be hot, so wear protective heat gloves.