

## Expand SmartStand



Bring your message to your target audience.



Size of the graphic in the image above  
23 5/8" Wide x 72" High



Size of the graphic in the image above  
27 9/16" Wide x 36" High



Size of the graphic in the image above  
31 1/2" Wide x 82" High

### Expand SmartStand

The Expand SmartStand is a flexible marketing display with a wide range of uses. The adjustable telescopic construction makes it quick and easy to vary the height and adapt the size of the image to suit your specific requirements. You can use it as a single or a double-

sided display, allowing you to double the impact in a snap whenever needed. The Expand SmartStand is attractively designed and takes up very little floor space. It is easy to assemble and is lightweight and comes in a padded nylon carry bag. Our Expand SmartStand helps you bring your message to wherever your target audience and is available with or without lighting. With our optional clip that snaps into the top profile, the unit can be hung in windows, on the wall or from the ceiling.

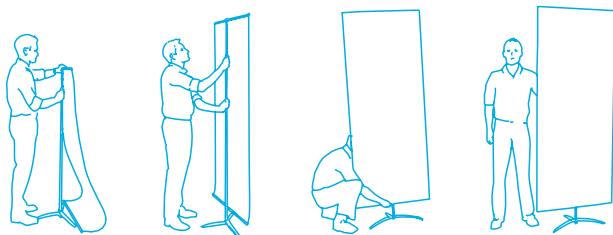

Widths: 19 11/16", 23 5/8", 27 9/16" & 31 1/2" (50, 60, 70 & 80 cm)  
Height: Adjustable up to 82 11/16" (Up to 210 cm)